

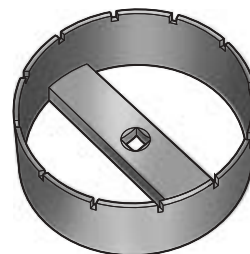

Service Tool Instructions

REV. 6-12-2001

Instruction Sheet ID: -J02135



HD-45324 FUEL CAP REMOVER/INSTALLER

General

To service the components of the fuel cap assembly, the fuel cap retainer will need to be removed. The Fuel Cap Remover/Installer (HD-45324) is used to remove and install the fuel cap retainer without damaging it.

NOTE

A Service Manual for your model motorcycle is available from your Harley-Davidson Dealer.

Removal

1. Remove Maxi-Fuse.
2. Disconnect the fuel hoses and wire harness from the fuel cap assembly.
3. See Figure 1. Place the Fuel Cap Remover/Installer (HD-45324) onto the fuel cap retainer, aligning the slots on the tool with the tabs on the retainer.
4. See Figure 2. Using a standard 1/2" drive socket wrench with a 3" driver extension, loosen the fuel cap retainer by turning it counterclockwise.
5. Once the retainer is loosened, it can be removed the rest of the way by hand.

i03807

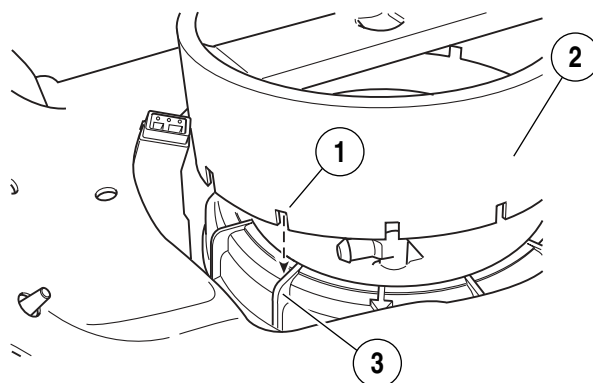

1. Slot
2. Remover/installer
3. Tab

Figure 1. Place Fuel Cap Tool onto Retainer

i03804

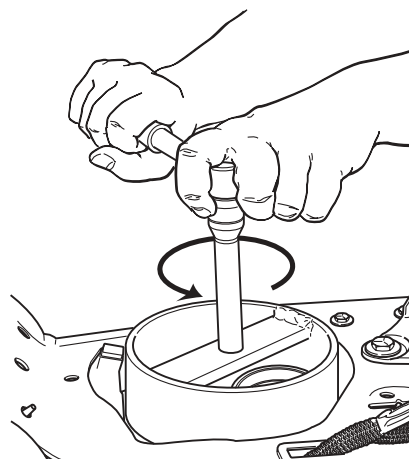

Figure 2. Loosen Retainer

Installation

1. After the fuel cap assembly has been serviced, install the assembly according to the instructions in the Service Manual.
2. See Figure 3. Align the arrow on the fuel cap retainer so that it is pointing toward the front.
3. Verify that the retainer is even and level as you begin to thread it onto the fuel tank.
4. Turn the fuel cap retainer clockwise by hand until it is snug. The retainer should still be even and level.

NOTE

If the fuel cap retainer is not even or level, the threads on the fuel tank or retainer could be damaged, the fuel cap assembly itself could be damaged, or the components of the fuel cap assembly may not function properly.

5. See Figure 4. Using torque wrench, tighten the fuel cap retainer to 61 Nm (45 ft-lbs).
6. Reconnect the fuel hoses and wire harness to the fuel cap assembly.
7. Install Maxi-Fuse.

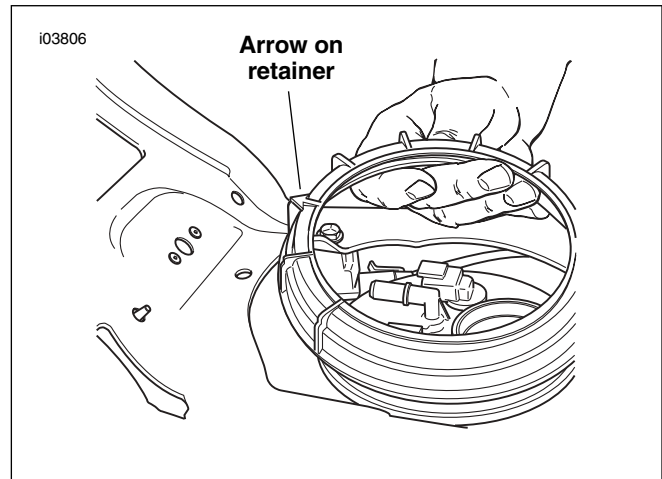

Figure 3. Align Retainer

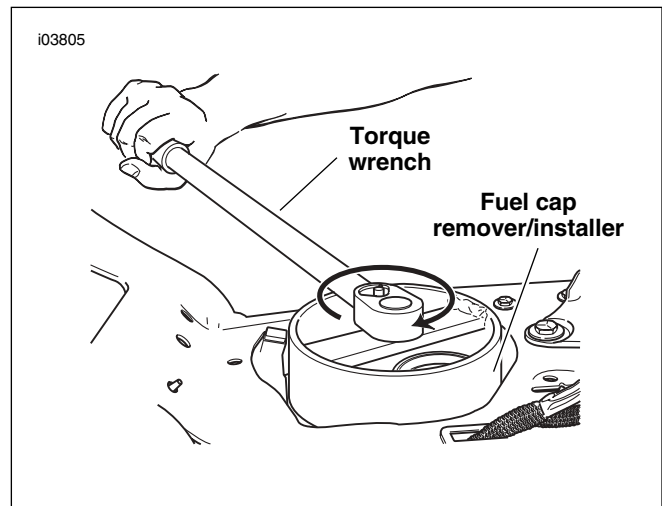

Figure 4. Tighten Retainer